



# Fitting Instructions

**BM29AU**  
TOWBAR **for**  
For BMW X5 (E70) **BM29Q**

## MATERIALS

A	1	Cross Bar
D	8	M12 x 40 x 3mm Washers and Lock Washers
E	1	M12 x 100mm x 1.75mm Bolts (Grade 10.9) and Nyloc Nut
Z99	1	Flip up electrical plate kit (including fitting instruction)

## For use with

**BM29AQ Detachable neck option – ZQ3024.** Please refer to ZQ fitting instructions for installation

## FITTING

1. Remove lower skirt of bumper (screws along lower edge, screws around each wheel arch, **1 screw beneath bumper reflectors** (reflectors are held in place by a spring clip, access to this is possible from inside bumper. The clip must be compressed, then slide the reflector towards the centre of the bumper) –Remove the plugs from inner wheel arch liner, prise away the wheel arch trim and undo tip screw each side. Prise off lower skirt starting at each corner. Where fitted disconnect reversing sensors. Remove bumper beam - retain original fixings.
2. Secure Cross Bar (A) to rear panel using original fixings. (Seal around Cross Bar (A) end plates to prevent ingress of water into chassis frame.)
3. **Fully tighten all bolts**
4. Please refer to ZQ and Z99 fitting instructions for fitment of Detachable Neck (ZQ) and Flip up electrical plate (Z99). Fit Bolt (E) as shown below.
5. Cut area shown below in lower plastic skirt.
6. Refit lower skirt etc.

**Recommended torque settings:** Grade 8.8 bolts: M8 - 24Nm, M10 - 52 Nm, M12 - 80 Nm, M14 - 130 Nm, M16 - 200 Nm **Grade 10.9:** M12 – 120Nm, M10 – 70Nm M8- 35Nm

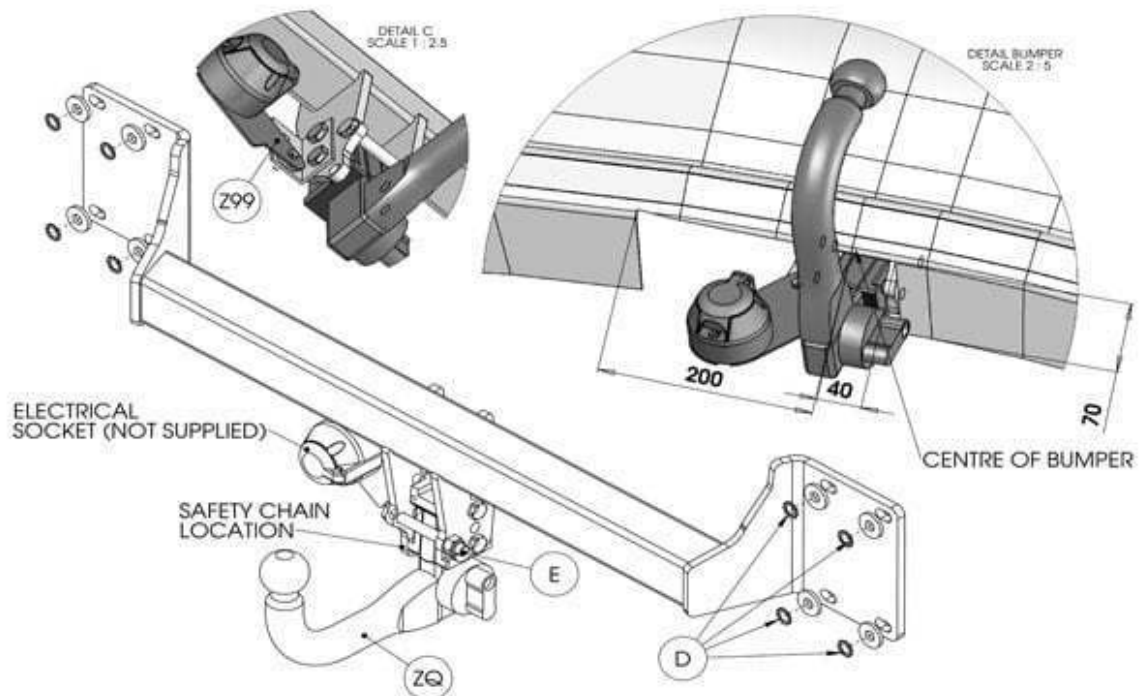

W0001BM29AU-FIT\$010912110000