



**TOWBAR FOR  
Chevrolet Captiva**  
(06/2013 - )  
**FITTING AND OPERATION MANUAL**

**Cat. No.C-280**

**DESTINATION**

Before the towbar assembly please refer to the manual and vehicle registration document whether car is adjusted for towing a trailer.  
Towbar C-280 is designed for towing a trailer.

**FITTING CONDITIONS**

Towbar C-280 can be used and operated in a car with proper technical conditions of body elements. Those parts cannot be mechanically damaged. Remove the insulating mass of the sealing from surface mounting. The towbar has to be installed and operated in a car according to this instruction. All bolts and nuts in towbar have to be screwed down with proper torque (Mo). Torque values are given below :

M6	-	10	(Nm)	M10	-	50	(Nm)
M8	-	25	(Nm)	M12	-	85	(Nm)

$$D = g \times \frac{T \times R}{T + R} \text{ kN}$$

D - technically permissible maximum mass in tonnes of the towing vehicle (also towing tractors) including, if necessary, the vertical load of a centrale axle trailer.  
R - technically permissible maximum mass in tonnes of the full trailer with drawbar force to move in the vertical plane or of the semi-trailer.  
g - acceleration due to gravity (assumed as 9,81 m/s<sup>2</sup>)

During operating individual elements of towbar should be kept in a proper technical condition and protected from corrosion. The trailer must be linked with an elastic joint with proper durability (cord, chain) while towing. It is necessary to check periodically bolt joints during operating the towbar. If screws are eased, it is necessary to screw them down.

**FITTING**

The tow bar C-280 is made up of the following elements :

1. Towbar mainframe	- 1 piece	13. Bolt M10x35	- 4 pieces
2. Tow ball mainframe	- 1 piece	14. Bolt M12x30	- 1 piece
3. Tow ball	- 1 piece	15. Bolt M12x40	- 8 pieces
4. Electrical socket plate	- 1 piece	16. Spring washer Ø10,2	- 4 pieces
5. Right support	- 1 piece	17. Spring washer Ø12,2	- 9 pieces
6. Left support	- 1 piece	18. Round washer Ø10,5	- 8 pieces
7. Right angle bar	- 1 piece	19. Round washer Ø13,0	- 5 pieces
8. Left angle bar	- 1 piece	20. Round washer Ø25,0	- 1 piece
9. Locking pin	- 1 piece	21. Nut M10	- 4 pieces
10. Cotter	- 1 piece	22. Nut M12	- 1 piece
11. Special washer 30xØ12,5x3	- 4 pieces	23. Self-locking nut M24x2	- 1 piece
12. Special washer Ø40/Ø12,5x3	- 2 pieces		

Please follow the installation fitting instruction below in order to ensure correct installation of the towbar:

1. Installation **requires removing and cutting of the rear bumper.**
2. Remove the rear bumper.
3. Remove the strengthening (the strengthening will be not reused).
4. Lower the silencers to facilitate access to the stringers.
5. Remove the towing eye (it will be not reused).
6. Attach the supports (5, 6) to the inner sides of the stringers and screw in points A using bolts M12x40 (15) with spring washers Ø12,2 (17) and round washers Ø13,0 (19).
7. Between supports (5, 6) slide the towbar mainframe (1) and screw in points B using bolts M10x35 (13) with round washers Ø10,5 (18), spring washers Ø10,2 (16) and nuts M10 (21), then screw in points C and D using bolts M12x40 (15) with spring washers Ø12,2 (17) and special washers Ø30/Ø12,5x3 (11) (In points D between stringers and supports (5, 6) place special washers Ø40/Ø12,5x3 (12)).
8. To the stringers screw the angle bars (7, 8), which mount the bumper, using bolts that were unscrewed from the strengthening of the bumper.
9. Determine and make a cutting in the rear bumper.
10. Install the silencers and the bumper using holes E and
11. Tighten the electrical socket plate (4) to the towbar mainframe (1) using bolt M12x30 (14) with round washer Ø13,0 (19), spring washer Ø12,2 (17) and nut M12 (22).
12. To the tow ball mainframe (2) screw the tow ball (3) with round washer Ø25,0 (20) and nut M24x2 (23) (torque 740 Nm).
13. To the tow bar mainframe (1) slide the tow ball mainframe (2) and lock the pin (9). Secure with cotter (10).

**Obeying this instruction assures correct montage and the C-280 towbar operating.**

After assembling of the towbar C-280 you have to get entry in cars registration book.

Keep tow ball clean, grease and cased. All damaged towbar cannot be repaired. In manufacturer do not take responsibility for arised

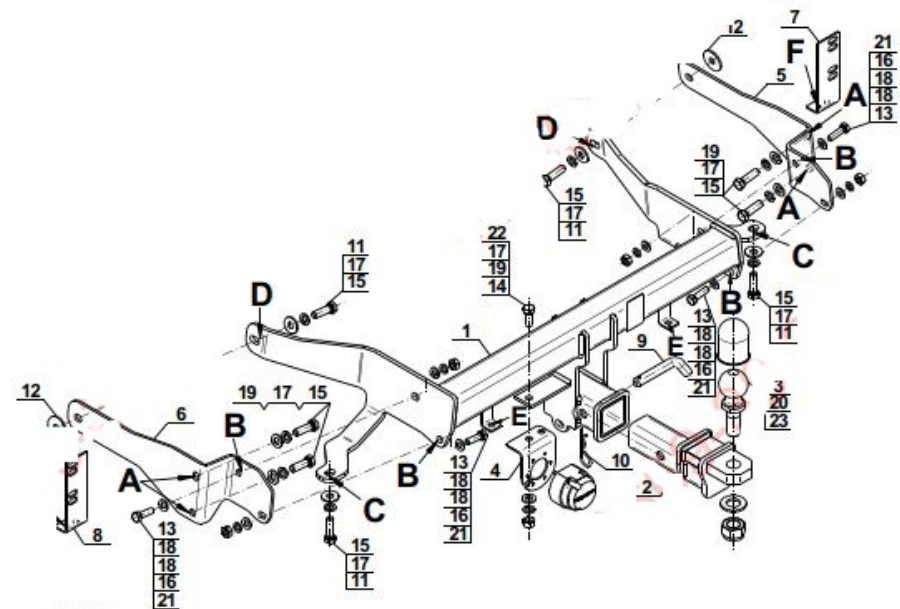

**NOTE :**

Bunch of wires is not included (In total price).

**Cat. No. C-280**